



## Potential Future Development Site or Home With Spacious Surrounds

Interest Over \$850,000

The home was built in approximately 1900 and has been lovingly looked after for years having retained many of its character features. With 3 bedrooms, a sleep out room, refurbished kitchen plus 3 separate living areas. In addition there are two large 3 bay sheds. Original features include high ceilings, timber floors (under the carpet), intricate cornice and this is an extremely solid home.

Set on 4388m<sup>2</sup> (over 1 acre) within minutes to the centre of Byron Bay. New zoning allows for future development of land subdivision or multi dwelling development (STCA).

The property is available to be purchased on its own or with the adjoining property being 1113m<sup>2</sup> at 300 Ewingsdale Road.

This is the first time in over fifty years that this special property has been available to the market.



**Su Reynolds**

Director | Sales | Chief  
Cultural Officer  
0428 888 660



This floor plan represents the current use of the property and does not claim to represent or confirm Council's approved plans and use of this property



**RESIDENCE - 127m<sup>2</sup>**  
**GARAGE - 180m<sup>2</sup>**  
**VERANDAH 11m<sup>2</sup>**

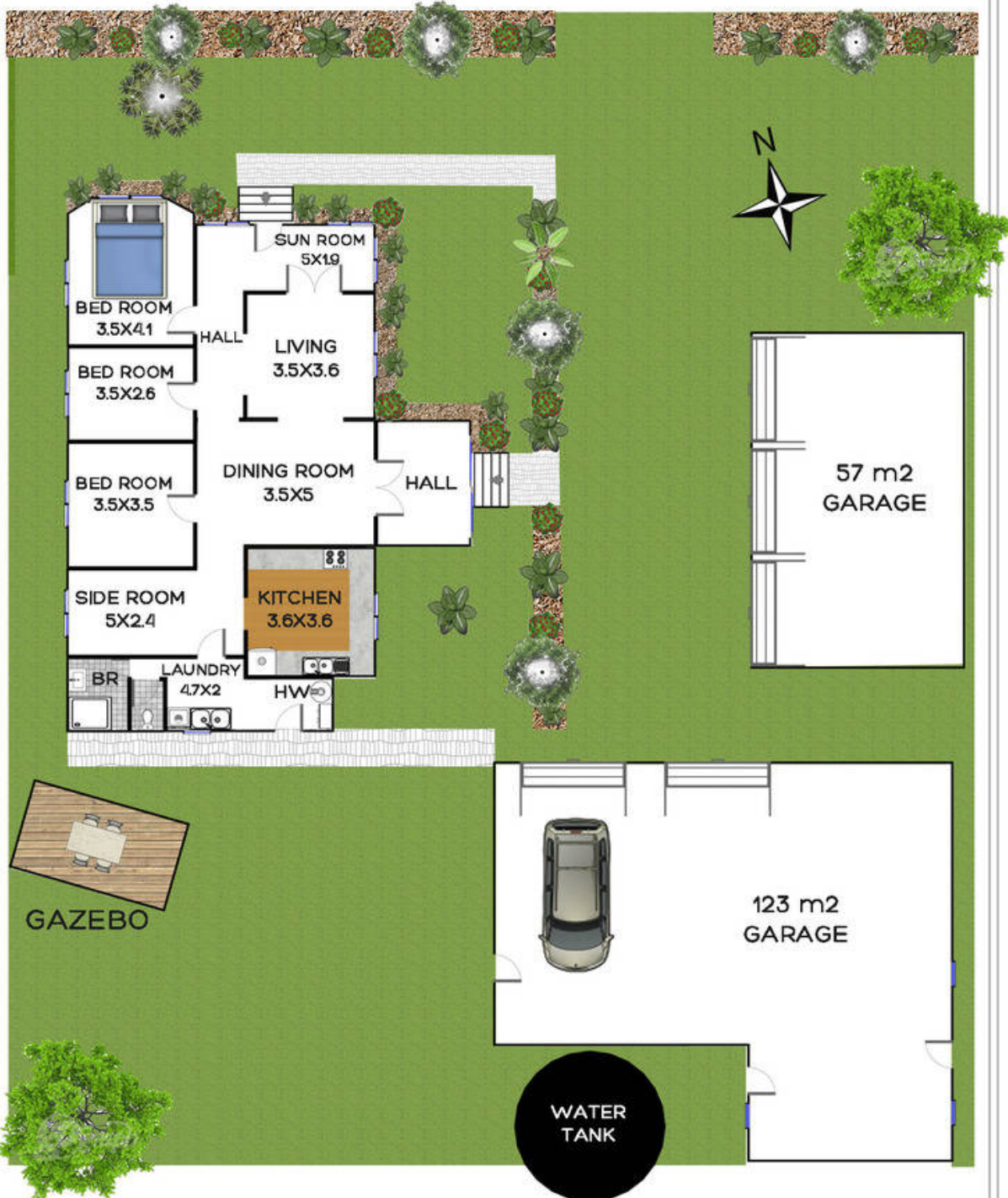

floor plan layout as illustration only - all figured dimensions approximate - do not scale - no liability accepted

