

Exquisite Quality - Spacious Private Home

\$2.3m - \$2.45m

Located in a sought-after area of Suffolk Park, is this large, modern family home with an exceptional level of detail in its design and quality in its finishes.

This stunning home built in 2011 by local award-winning builders, Todd Knaus Constructions, has been meticulously planned for an ideal tropical family lifestyle and offers exceptional privacy.

The north facing, open plan kitchen, dining and living space features soaring 10-13 foot ceilings with large sliding doors seamlessly connecting to the outdoor entertainment area, private yard and pool. Louvre windows create light and air flow, giving the main area of the home a spacious feel.

Stunning travertine flooring throughout the living area adds style and simplicity for easy, effortless living. The bespoke timber lined kitchen with a large stone island bench and quality appliances overlooks the alfresco pool area making this home ideal for anyone who loves to entertain.

Outdoors feature covered solid timber deck and north facing, low maintenance, landscaped garden and solar heated saltwater pool.

With 4 large bedrooms and a separate soundproof media room, this property has space for a large or growing family.

The bedrooms have built in robes for convenient storage, automated blinds, ducted air conditioning, ceiling fans and carpet. The main bedroom overlooks the pool offering your own private tropical paradise with private ensuite, ducted air conditioning and ceiling fan.

With 2 separate bathrooms each with heated tiles and wired controls, plus a separate laundry room, the space is well thought out and considers the needs of the whole family.



Su Reynolds

Director | Sales | Chief
Cultural Officer
0428 888 660



Luke Elwin

Sales
0421 375 635



A 2-car secure garage offers extra storage and gives you the option to leave the car at home and hit the local bike paths to the heart of Byron Bay, a 5-minute ride to the pristine sands of Tallow Beach or a 3 minute walk to the local sporting fields.

FEATURES

- Ducted Air Conditioning
- Extensive rock walls in landscaping
- Solar panels 6.6kw
- Gas cooking
- Solar hot water system
- Water tank plus town water
- Ceiling fans
- Fully fenced and secure
- Bose sound system
- Heated towel rails
- Heated bathroom floors
- Solar heated saltwater pool
- North facing living and garden
- Outdoor shower

Council Rates: \$3,566.18 p/a

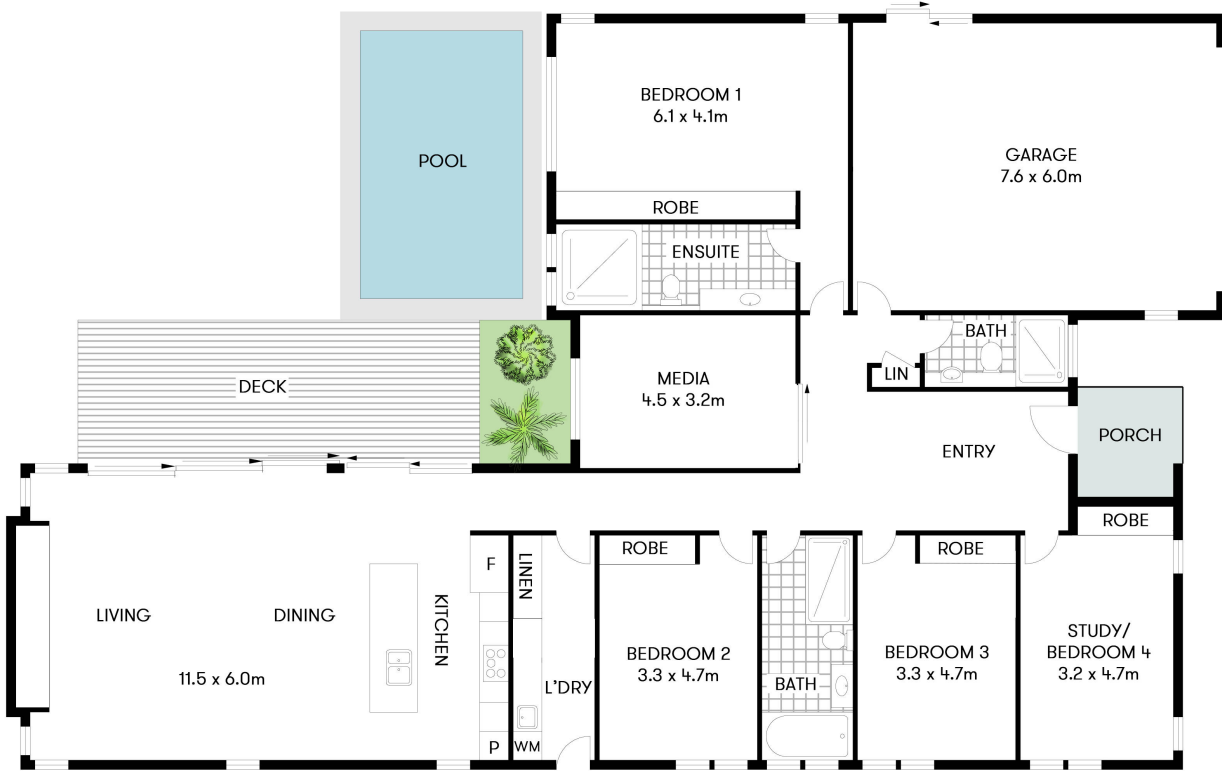

11 DEHNGA PLACE, SUFFOLK PARK

INTERNAL: 261m² | EXTERNAL: 36m²

FIRST NATIONAL BYRON
YOUR HOME | YOUR LIFE | YOUR STORY

Scale in metres. Indicative only. All information contained herein is obtained from sources we believe to be accurate. We cannot guarantee its accuracy. Interested persons should make and rely on their own enquiries. This plan is a representation of the buildings on site and not an indication of council approval. Floorplan as illustration only – all figured dimensions approximate – do not scale – no liability accepted

