

18 Lush Acres with Stunning Lighthouse Views only minutes to Byron Bay

\$3.3M - \$3.6M

This truly unique Ewingsdale address is sprawled over 18 acres of largely cleared land and boasts expansive views to Cape Byron and beyond.

Featuring dual road access off Myocum Road and a main driveway off Possum Shoot Road, the lush undulating hills are picture perfect and there is a prime building site (STCA) at the top of the property with 180 degree views of the ocean through to the mountain ranges. You get the best of sunrises and sunsets!

A natural spring feeds a private pond and supplies the house, providing an excellent addition to the two main water tanks with ample supply to explore any number of gardening and farming pursuits.

The main house is only 8 years old and offers open plan living with separate media room. The east-facing deck is perfect for enjoying the dreamy coloured sunsets and watching the lighthouse shine under the stars.

The main bedroom has a walk-in robe and ensuite, including bath and separate toilet. The second and third bedrooms both have built-in robes. A dedicated study space and large double garage with internal access plus plenty of external parking round out this comfortable family home.

The second dwelling is the original farmhouse. Although currently decommissioned it was built in the early 1900s and offers a glimpse into life on the land in years gone by. The possibilities are endless as to how it could be revived! (STCA)

Less than 10 minutes to Byron Bay's world class beaches, shopping, eateries and nightlife. This address is also central to Bangalow, Newrybar, Federal, Mullumbimby, Brunswick Heads and New Brighton, giving you



Tara Torkkola

Sales
0423 519 698

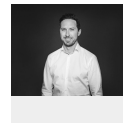

Denzil Lloyd

Sales
0481 864 049



First National Byron
The value of trust

299 Myocum Road, Ewingsdale NSW 2481

House: 6 beds 3 baths

access to four farmers markets each week no more than 15 minutes from home. The Farm and Three Blue Ducks Restaurant are just 3.5kms up the road.

This rare opportunity has so much to offer and so much potential. Please call Tara or Denzil to arrange your private viewing today.

Council Rates: \$3,915.00 p/a

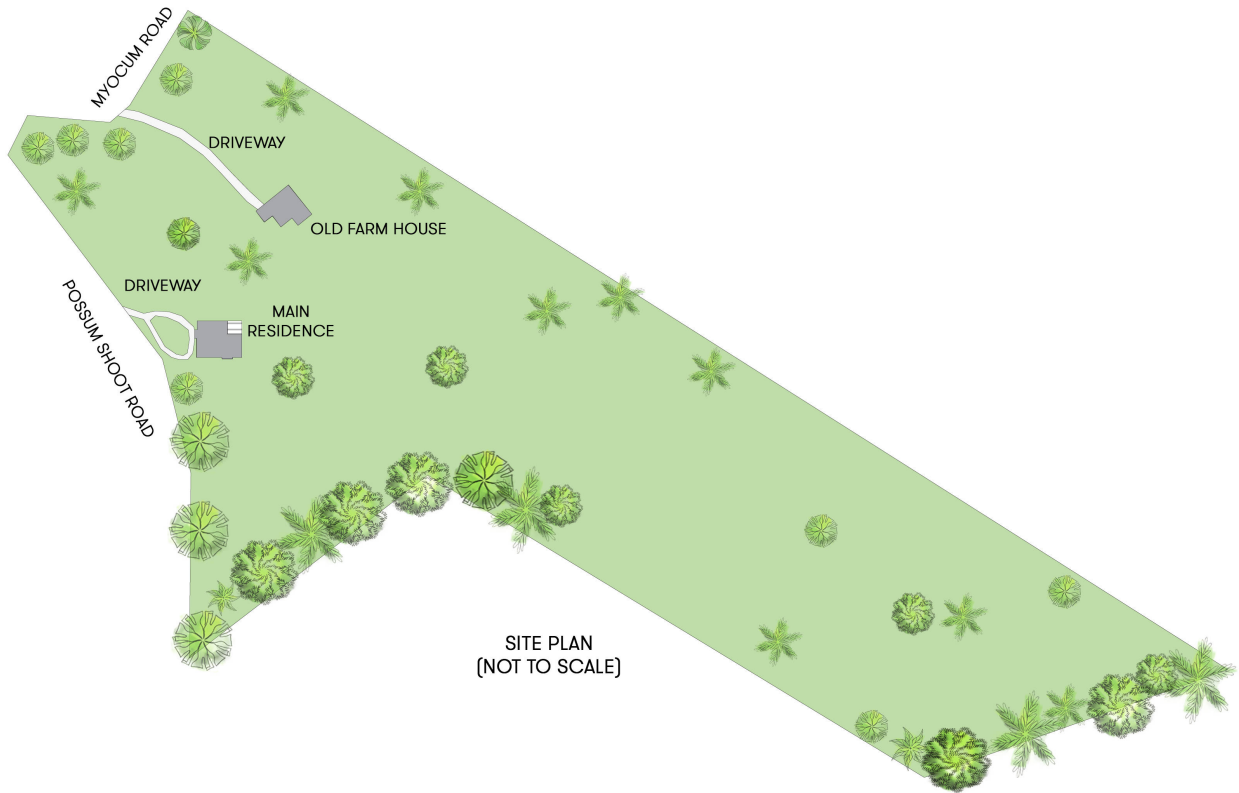

299 MYOCUM ROAD, EWINGSDALE

INTERNAL FLOOR SPACE: 398m²

FIRST NATIONAL BYRON
YOUR HOME | YOUR LIFE | YOUR STORY

Scale in metres. Indicative only. All information contained herein is obtained from sources we believe to be accurate. We cannot guarantee its accuracy. Interested persons should make and rely on their own enquiries. This plan is a representation of the buildings on site and not an indication of council approval. Floorplan as illustration only – all figured dimensions approximate – do not scale – no liability accepted

